

STOCKTON DIESEL FACILITY

HISTORY - A PREFAB 10-STALL CONCRETE ROUNDHOUSE AND AN ADJACENT MACHINE SHOP WAS BUILT HERE IN 1927 AND IS PART OF THE PRESENT COMPLEX. A LARGE ADDITION WAS BUILT IN 1969 AND NOW SERVES AS THE MAJOR LOCOMOTIVE FACILITY ON THE WESTERN PACIFIC.

THE NEW SHOP BUILDING ENCOMPASSES AN AREA OF 42,400 SQUARE FEET, THE ROUNDHOUSE 20,300 SQUARE FEET, A STORAGE/STORE/TRAINING CENTER 9,300 SQUARE FEET AND THE LAB AND ENGINEERING OFFICE 1,500 SQUARE FEET. THE HEAVY REPAIR BAY PORTION IN THE NEW SHOP HAS A CAPACITY OF TWO LOCOMOTIVES AND IS EQUIPPED WITH A 30-TON OVERHEAD TRAVELING CRANE. THE RUNNING REPAIR PORTION OF THE NEW SHOP HAS A CAPACITY OF 10 LOCOMOTIVES COMBINED ON TWO THROUGH TRACKS AND ONE STUB TRACK. TWO OF THESE TRACKS ARE EQUIPPED WITH A DROP TABLE WHICH RELEASES IN THE HEAVY REPAIR BAY. TWO FIVE-TON OVERHEAD TRAVELING CRANES ARE ALSO IN PLACE. THE ROUNDHOUSE HAS SEVEN STALLS USED PRINCIPALLY FOR SWITCH ENGINE REPAIR AND HEAVY WRECK WORK. TWO ADDITIONAL STALLS ARE USED FOR HEAVY MATERIAL STORAGE AND ONE STALL HAS BEEN CONVERTED TO A PAINT SHOP WHERE TWO UNITS PER MONTH ARE COMPLETELY REPAINTED. FIVE ADDITIONAL TRACKS RADIATE FROM THE TURN-TABLE. WITHIN THIS COMPLEX ARE LOCATED A COMPLETE TOOL ROOM, AIR BRAKE SHOP, ELECTRICAL SHOP, AND A COMPONENT PARTS ROOM, WHICH PROVIDES FOR REBUILDING OF RADIATORS, OIL COOLERS, WATER PUMPS, JOURNAL BOXES, AIR COMPRESSORS AND RENOVATION OF REBUILDING OF SIMILAR COMPONENTS.

THREE OUTSIDE SERVICE TRACKS ARE PROVIDED, ONE OF WHICH HAS A PIT. FIVE RUEL RISERS ARE LOCATED BETWEEN THESE TRACKS AS WELL AS AN AUTOMATIC WASH RACK. FORTY-FIVE UNITS ARE SERVICED AND DISPATCHED ON A DAILY BASIS.

STORAGE CAPACITY AT THIS FACILITY IS 160,000 GALLONS - DIESEL FUEL AND 20,000 GALLONS - LUBE OIL. ADDITIONAL FUEL CAPACITY IN THE AMOUNT OF 2,200,000 GALLONS IS LOCATED ON ROUGH AND READY ISLAND, SOME FOUR MILES AWAY AND SUPPLIES THIS FACILITY VIA A COMPANY PIPELINE.

STANDARD OIL MAINTAINS A LAB FOR TESTING OF LUBE OILS AND THEIR PERFORMANCE AND EXPERIMENTS IN FUEL CONSERVATION.

PERIODIC MAINTENANCE ON A MONTHLY BASIS AT THIS SHOP IS:

89 MONTHLIES  
9 QUARTERLIES  
15 SEMIS  
26 ANNUALS  
110 TRUCK LUBES

MAJOR PARTS REPLACED DURING 1979 WERE:

180 TRACTION MOTORS  
37 TURBOS  
7 MAIN GENERATORS  
18 AIR COMPRESSORS  
4 AR-10 ALTERNATORS  
7 UNIT EXCHANGE ENGINES

WE ALSO OVERHAULED 16 LOCOMOTIVE ENGINES, PERFORMED MAJOR ELECTRICAL WORK ON 10 LOCOMOTIVES. AIR EQUIPMENT IS REPLACED ON THE ENTIRE FLEET EVERY TWO YEARS. WRECK REPAIRS ARE ALSO PERFORMED IN THIS PLANT.

---

AVERAGE FUEL USAGE PER MONTH	909,000 GAL.
AVERAGE LUBE OIL USAGE PER MONTH	37,320 GAL.

FORCE REPORT

STOCKTON DIESEL FACILITY

	<u>Authorized</u>	<u>Working</u>	<u>Other</u>
Clerks	2	2	
Formen	11	11	
Sheetmetal Workers	15	15	
Electricians	23	23	2 (a)
Machinists	55	55	4 (b)
Hostler Helpers	7	7	1 (c)
Laborers	20	20	
Painters	2	2	
Loco. Carpenters	1	1	
Boilermakers	8	8	
Machinists Helpers	5	5	
Electrician Apprentices	2	2	
Machinists Apprentices	8	8	
Electrician Helpers	1	1	
Hostlers	<u>5</u>	<u>5</u>	
TOTAL	165	165	

(a) E.D. Weeks, 3/31/80; W. F. White, 6/15/79, Medical

(b) V.D. Parker, 3/22/80; S. Teddelton, 4/14/80; L. Foster, 3/30/80,  
Sick.

(c) K. Fergeson, 2/26/80, Sick.

---

AVERAGE PAYROLL PER MONTH

\$268,760.00

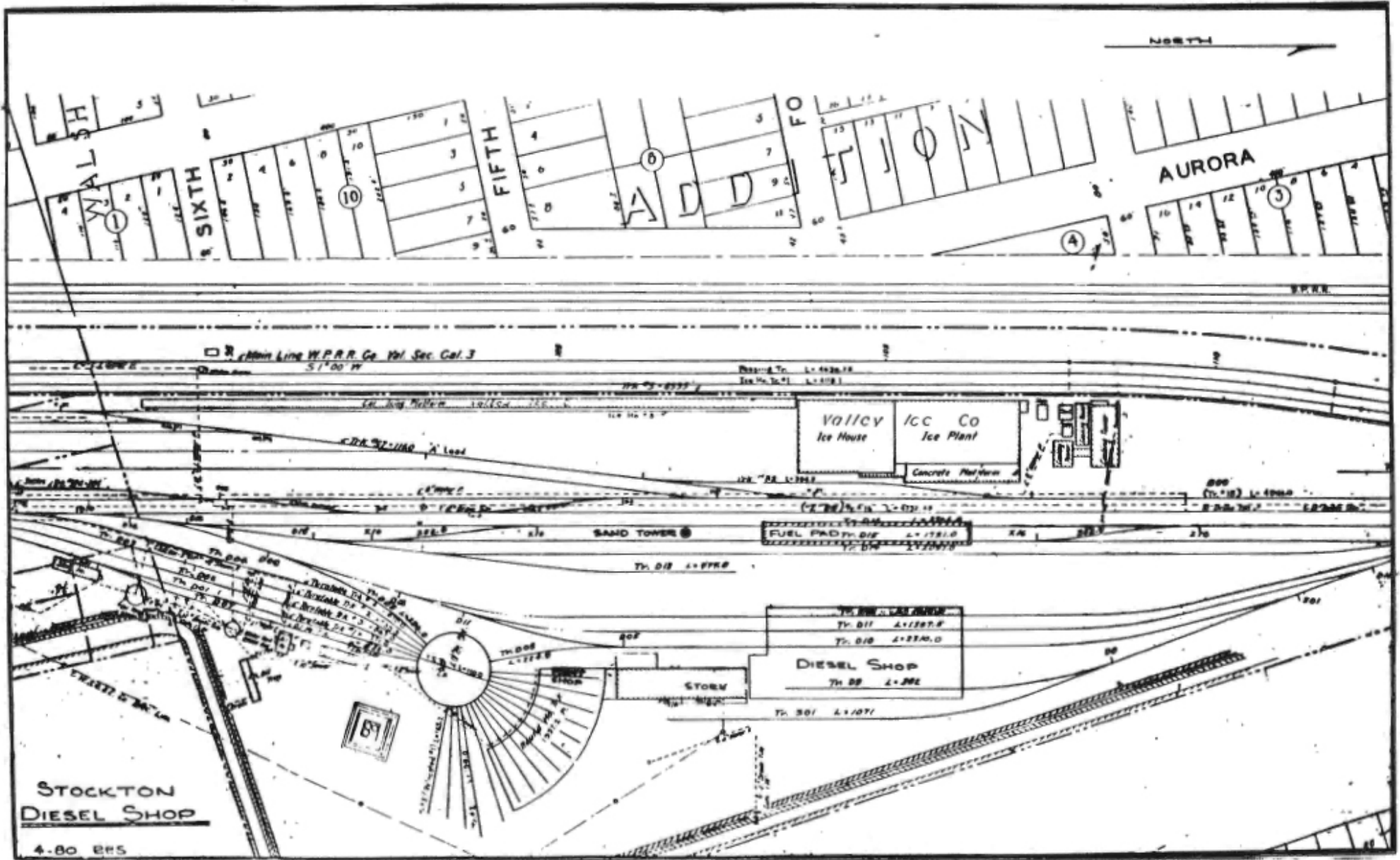

NORTH

WALSH  
SIXTH  
FIFTH  
ADDISON  
AURORA

Main Line W.P.R.R. Co. Vol. Sec. Cal. 3  
S1°00' W

Valley Ice Co  
Ice House  
Ice Plant

Concrete Platform

SAND TOWER

FUEL PAD FOR DIE  
L-1781.0  
W-272.0

DIESEL SHOP  
TH 88 L-1071

STOCKTON  
DIESEL SHOP

4-80 BBS